

SPRING GOLD WAY
MAIN FLOOR
2345 SQ. FT.

9FT. - 15FT. VAULTED CEILING

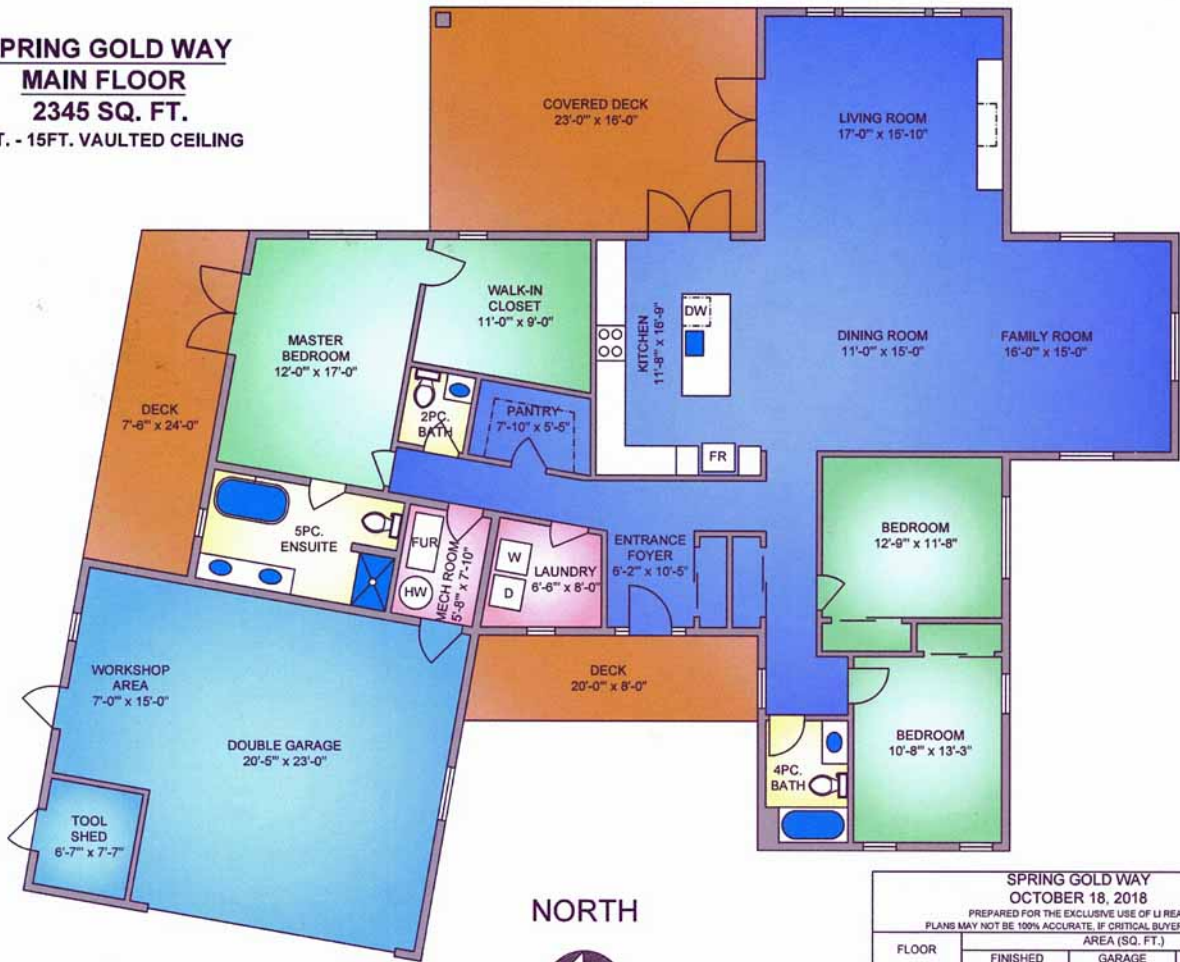

NORTH



SPRING GOLD WAY			
OCTOBER 18, 2018			
PREPARED FOR THE EXCLUSIVE USE OF LJ READ			
PLANS MAY NOT BE 100% ACCURATE. IF CRITICAL, BUYER TO VERIFY.			
FLOOR	AREA (SQ. FT.)		
	FINISHED	GARAGE	DECK / PATIO
MAIN	2345	676	672
TOTAL	2345	676	672